

S + 160 LA28 (3 or 6 mm pitch) and LA28 strong motor
(with or without safety nut.)

S + 171 splines

S + 185 safety nut and splines

S + 192 brake

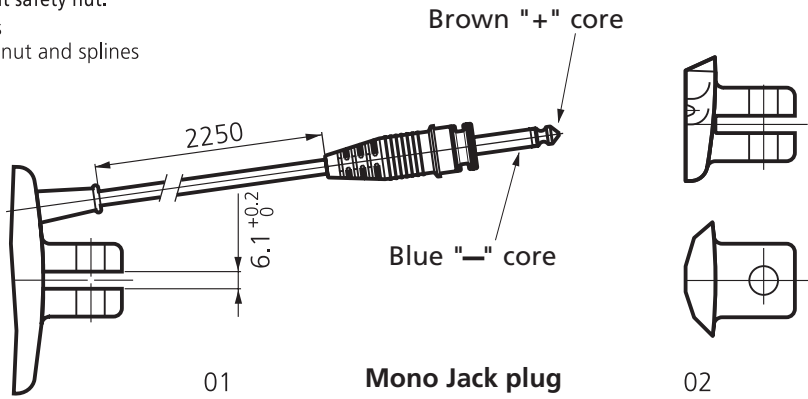
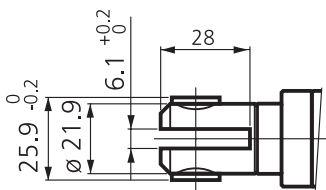

01

Mono Jack plug

02

LINAK A/S
LA28001A

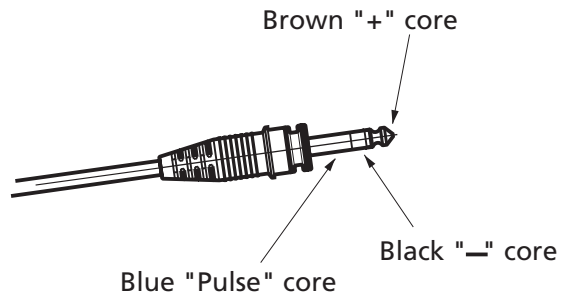

Stereo Jack plug

All rights reserved

Date:

17 June 2010

Description:

Linear Actuator LA28



WE IMPROVE YOUR LIFE